

# *Rowlett*

**Hand blender**  
Instruction manual



**Model:**  
**CU742-A**

## Safety Instructions

Please take a few moments to carefully read through this manual. Correct maintenance and operation of this machine will provide the best possible performance from your Rowlett product. Save these instructions.

- A service agent/qualified technician should carry out installation and any repairs if required. Do not remove any components on this product.
- Consult Local and National Standards to comply with the following:
  - Health and Safety at Work Legislation
  - Fire Precautions
  - IEE Wiring Regulations
  - Building Regulations
- Before use check that the voltage of your power supply corresponds to the one shown on the rating plate.
- DO NOT operate the unit if damaged.
- To protect against electrical shock, do not put motor unit in water or any other liquid.
- **Blade is sharp – handle carefully.**
- The use of accessory attachments not recommended or sold by Rowlett may cause fire, electric shock, or injury, which will invalidate your guarantee.
- DO NOT remove food from the appliance until the blending attachments have come to a complete stop.
- Avoid contacting moving parts. Keep hands, hair, clothing and utensils away from blending attachment and container while operation to prevent the possibility of severe injury to persons and/or damage to the appliance.
- DO NOT use jet/pressure washers to clean the appliance.
- DO NOT use to blend hard and dry substances. Otherwise the blade could be blunted.
- Do not let cord hang over edge of table or hot surface.
- Do not blend hot liquids.

- Always switch off and disconnect from the power supply when not in use, before putting on or taking off parts, before approaching moving parts, and before cleaning. Always disconnect the blender from the power supply if it is left unattended.
- Not suitable for outdoor use.
- Keep all packaging away from children. Dispose of the packaging in accordance to the regulations of local authorities.
- If the power cord is damaged, it must be replaced by a Rowlett agent or a recommended qualified technician in order to avoid a hazard.
- This appliance can be used by persons with reduced physical, sensory or mental capabilities or lack of experience and knowledge if they have been given supervision or instruction concerning use of the appliance in a safe way and understand the hazards involved.
- Close supervision is necessary when your appliance is being used near children or infirm persons.
- This appliance shall not be used by children. Keep the appliance and its cord out of reach of children. Do not allow children to use the blender without supervision.
- Rowlett recommend that this appliance should be periodically tested (at least annually) by a Competent Person. Testing should include, but not be limited to: Visual Inspection, Polarity Test, Insulation Continuity and Functional Testing.

## Pack Contents

The following is included:

- Hand blender
- Attachment adapter
- Chopper blade
- Shaft
- Balloon whisk
- Chopper bowl
- Blending jar
- Chopper lid
- Instruction manual

Rowlett prides itself on quality and service, ensuring that at the time of unpacking the contents are supplied fully functional and free of damage.

Should you find any damage as a result of transit, please contact your Rowlett dealer immediately.

## Assembly

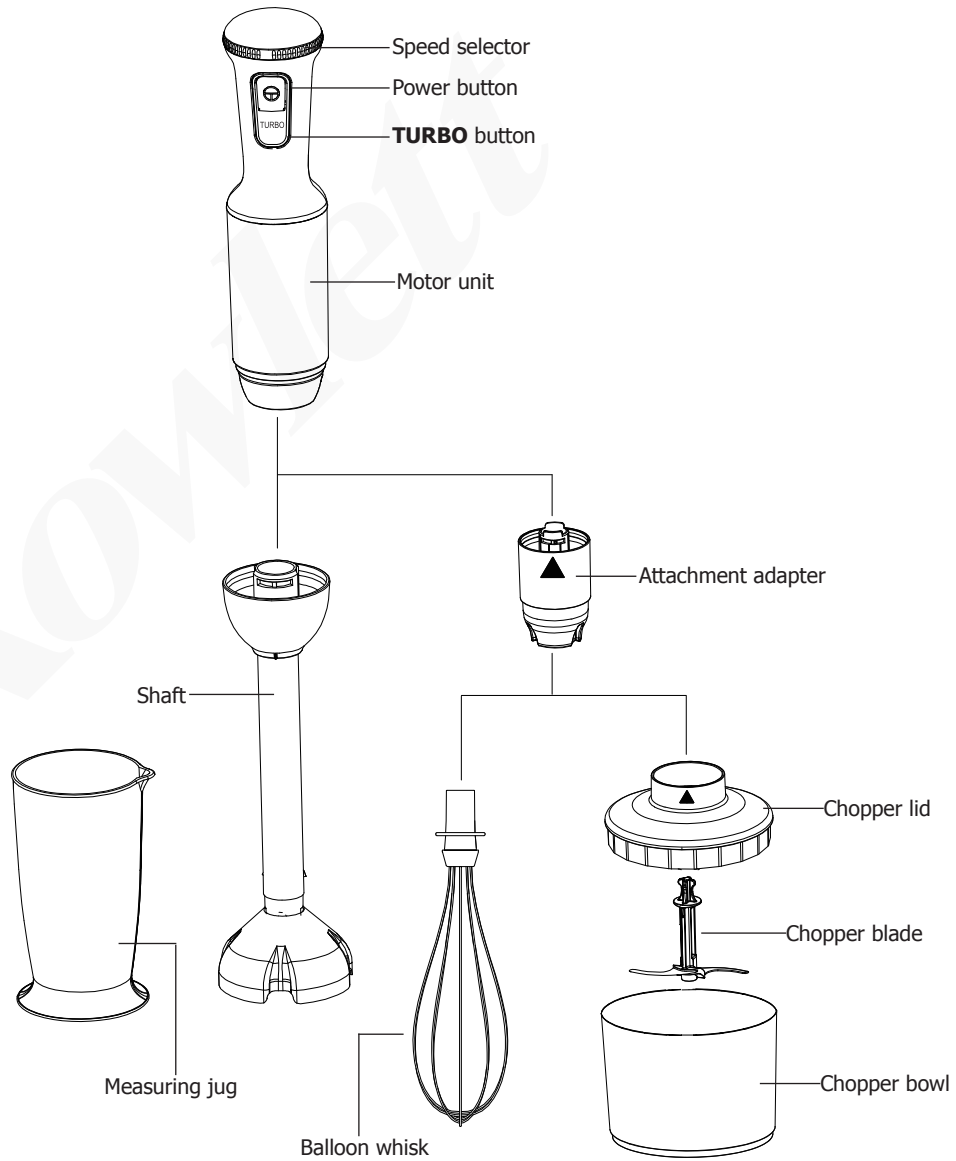

Before assembly, ensure to clean all parts that come into contact with food with warm soapy water. For details, refer to section "Cleaning, care & maintenance".

**Blades are very sharp!** Be careful when handling blades, especially when emptying the bowl and during cleaning.

Rowlett accept no responsibility for any injury caused by incorrect assembly/disassembly.

### Mounting blender shaft

1. Align the arrow mark on the shaft with the Eject button on the motor unit.
2. Insert the shaft into motor part until locked in place.

### Mounting balloon whisk

1. Insert the balloon whisk into the attachment adapter.
2. Mount the adapter onto the motor unit.

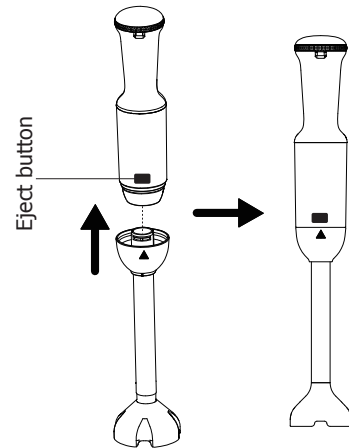

### Mounting chopper assembly

- **Always ensure the chopper bowl is in place before inserting the chopper blade.**
- **Be sure the chopper lid is locked in place before operation.**

1. Place the chopper bowl on a flat surface, then insert the chopper blade.
2. Add food in the bowl and locate the chopper lid.
3. Fix one end of the attachment adapter on the motor unit, then the other end on the chopper lid.

## Operation

Blending	Beating/whisking	Chopping
<ul style="list-style-type: none"> <li>• Lower the shaft or balloon whisk into food.</li> </ul>		
<ul style="list-style-type: none"> <li>• Connect the appliance to the power supply.</li> <li>• Press and hold the power button to start. If desired, use the speed selector to adjust the speed.</li> <li>• During operation, you can also press the "TURBO" button to run at the highest speed. In turbo mode, do not let the motor run for more than 15 seconds.</li> <li>• After each use, release the power button or "TURBO" button to stop. Disconnect from power supply and let attachments come to a full stop.</li> <li>• To remove the attachments, hold them with one hand and press the Eject button with the other hand.</li> </ul>		
Max working time per cycle: 1 minute Interval during cycles: 3 minutes	Max working time per cycle: 2 minutes Interval during cycles: 10 minutes	Max working time per cycle: 30 seconds Interval during cycles: 10 minutes

- **Be careful of potential injury from misuse.**
- **During use, never let the blending attachments face towards people or objects. Risk of damage or injury!**
- **It is recommended to tilt the bender slightly to prevent the blade guard from touching the bottom of the container.**

## Removing the lodged food

If a piece of food gets lodged onto the attachments, please follow the instructions below:

1. Release the power button to stop, then disconnect from power supply and let it come to a complete stop.
2. Press the Eject button to release the attachments, then use a rubber/wooden spatula to remove the food lodged. **Caution: The blade is sharp - Never attempt to use fingers to remove any lodged object.**

## Recipe

Recipe below is provided for references only.

### Blending carrot into pulp:

Attachment: shaft

Instructions: Put 280g carrot (pre-cut into pieces) and 420g water into the measuring jug; Start with low speed then use Turbo function for 15 seconds. Repeat the cycle until carrot is blended into fine pulp.

### Chopping meat:

Attachment: Chopper assembly

Instructions: Remove bone from meat, cut meat into pieces and put in the bowl. Max quantity of meat cannot exceed 200g in every processing. Start with low speed then use Turbo function for 15 seconds. Repeat the cycle until meat is minced.

## Beating egg white into foaming shape:

Attachment: Balloon whisk

Instructions: Pour egg white in the jug. Normally 2 eggs' white is enough. Run the appliance for 2 minutes and repeat if necessary.

## Cleaning, Care & Maintenance

- **Before cleaning, always disconnect motor unit from power supply, let it cool down and come to a full stop.**
- Clean the motor unit surface with a damp cloth. Never immerse the motor part in water or rinse it under running water.
- Use warm soapy water to clean blending attachments, jug and bowl. Do not use abrasive cleaning chemicals as these can leave harmful residues.
- Dry all parts thoroughly after cleaning.
- **Always dry the blades well after cleaning to avoid spotting.**
- **Measuring jug and chopper bowl can not be used to store food for long time.**

## Quick cleaning

Between processing tasks, hold the blender in a container half filled with water and let it run for a few seconds (Never exceeding 15 seconds).

## Troubleshooting

A qualified technician must carry out repairs if required.

Fault	Probable Cause	Solution
The appliance is not working	The unit is not switched on	Check the unit is plugged in correctly and switched on
	Plug or lead is damaged	Replace plug or lead
	Mains Power supply fault	Check Mains Power supply
Appliance slows down	Too many contents in the container	Turn off the unit and remove some of the contents. Adjust the food formula if needed
	Wrong mixing attachment used	Select suitable attachment
Loud noise	Mixing attachments not correctly fitted	Remove and refit attachments
	Mixing attachments deforms	Contact a qualified technician

## Technical Specifications

Note: Due to our continuing program of research and development, the specifications herein may be subject to change without notice.

Model	Voltage	Power	Dimensions H x W x D mm	Weight (kg)
CU742-A	220-240V~, 50Hz	300W	416 x 56 x 56	1.33kg

## Electrical Wiring

The plug is to be connected to a suitable mains socket.

This appliance is wired as follows:

- Live wire (coloured brown) to terminal marked L
- Neutral wire (coloured blue) to terminal marked N

If in doubt consult a qualified electrician.

Electrical isolation points must be kept clear of any obstructions. In the event of any emergency disconnection being required they must be readily accessible.

## Compliance

The product must not be disposed of as household waste. To help prevent possible harm to human health and/or the environment, the product must be disposed of in an approved and environmentally safe recycling process. For further information on how to dispose of this product correctly, contact the product supplier, or the local authority responsible for waste disposal in your area.

Rowlett parts have undergone strict product testing in order to comply with regulatory standards and specifications set by international, independent, and federal authorities.

Rowlett products have been approved to carry the following symbol:



**All rights reserved. No part of these instructions may be produced or transmitted in any form or by any means, electronic, mechanical, photocopying, recording or otherwise, without the prior written permission of Rowlett. Every effort is made to ensure all details are correct at the time of going to press, however, Rowlett reserve the right to change specifications without notice.**

# DECLARATION OF CONFORMITY

- Conformiteitsverklaring • Déclaration de conformité • Konformitätserklärung • Dichiarazione di conformità • Declaración de conformidad • Declaração de conformidade

<b>Equipment Type</b> • Uitrustingstype • Type d'équipement • Gerätetyp • Tipo di apparecchiatura • Tipo de equipo • Tipo de equipamento	<b>Model</b> • Modèle • Modell • Modello • Modelo • Malli
<b>Hand Blender</b>	CU742-A
<b>Application of Territory Legislation &amp; Council Directives(s)</b> Toepassing van Europese Richtlijn(en) • Application de la/des directive(s) du Conseil • Anwendbare EU-Richtlinie(n) • Applicazione delle Direttive • Aplicación de la(s) directiva(s) del consejo • Aplicação de directiva(s) do Conselho	<b>Electrical Safety</b> AS/NZS 60335.1:2020 AS/NZS 60335.2.14:2017 +A1  <b>Electro-Magnetic Compatibility (EMC)</b> EN IEC 55014-1:2021 EN IEC 55014-2:2021 EN IEC 61000-3-2: 2019 +A1:2021 EN 61000-3-3: 2013 +A1:2019 +A2:2021
<b>Producer Name</b> • Naam fabrikant • Nom du producteur • Name des Herstellers • Nome del produttore • Nombre del fabricante • Nome do fabricante	<b>Rowlett</b>

I, the undersigned, hereby declare that the equipment specified above conforms to the above Territory Legislation, Directive(s) and Standard(s).

Ik, de ondergetekende, verklaar hierbij dat de hierboven gespecificeerde uitrusting goedgekeurd is volgens de bovenstaande Richtlijn(en) en Standaard(en).

Je soussigné, confirme la conformité de l'équipement cité dans la présente à la / aux Directive(s) et Norme(s) ci-dessus  
 Ich, der/die Unterzeichnende, erkläre hiermit, dass das oben angegebene Gerät der/den oben angeführten Richtlinie(n) und Norm(en) entspricht.

Il sottoscritto dichiara che l'apparecchiatura di sopra specificata è conforme alle Direttive e agli Standard sopra riportati.  
 El abajo firmante declara por la presente que el equipo arriba especificado está en conformidad con la(s) directiva(s) y estándar(es) arriba mencionadas.

Eu, o abaixo-assinado, declaro que o equipamento anteriormente especificado está em conformidade com a(s) anterior(es) Directiva(s) e Norma(s)

**Date** • Data • Date • Datum • Data • Fecha • Data

**Signature** • Handtekening • Signature  
 • Unterschrift Firma • Firma • Assinatura

**Full Name** • Volledige naam • Nom et prénom • Vollständiger Name • Nome completo • Nombre completo • Nome por extenso

**Position** • Functie • Fonction • Position  
 • Qualifica • Posición • Função

**Producer Address** • Adres fabrikant • Adresse du producteur • Anschritt des Herstellers • Indirizzo del produttore • Dirección del fabricante • Morada do fabricante

26<sup>th</sup> May 2023

DocuSigned by:

*Ashley Hooper*  
 B39382C9FD9C478...

Ashley Hooper

Technical & Quality Manager

Fourth Way,  
 Avonmouth,  
 Bristol,  
 BS11 8TB  
 United Kingdom

DocuSigned by:

*Brendan Denmeade*  
 D052C5837EB7465...

Brendan Denmeade

Commercial Manager/ Responsible Supplier

15 Bagdally Road,  
 Campbelltown  
 NSW 2560









***Rowlett***

CU742-A\_A5\_v1\_2023/06/06